

- 1 A gardener decides to lay a new path next to his lily pond.
The drawing shows the dimensions of the path.

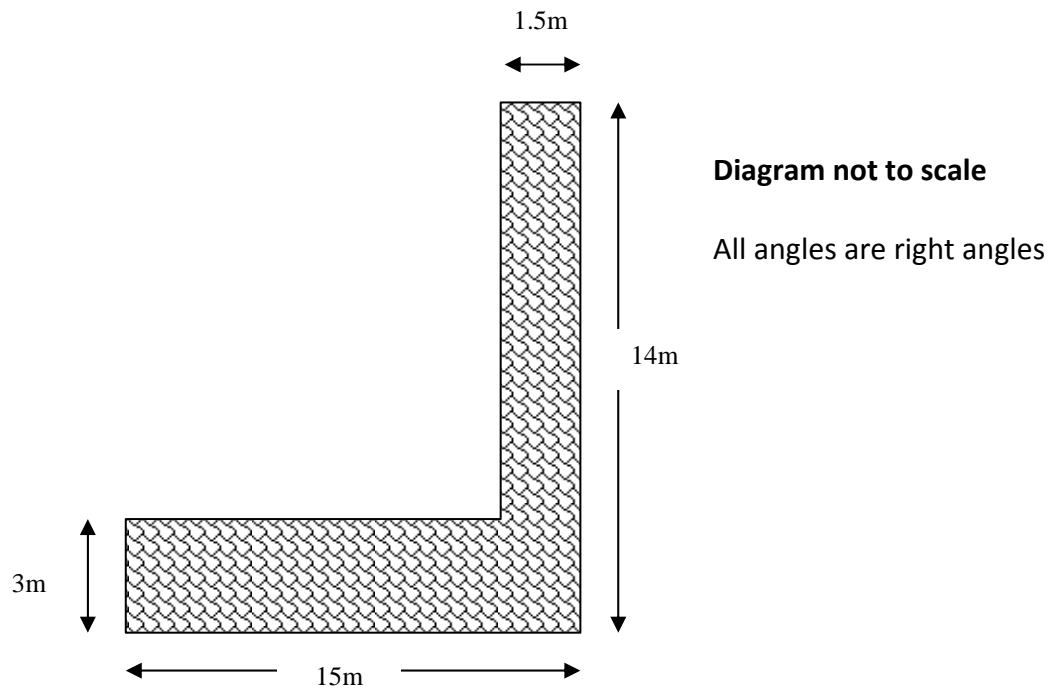

What is the total area of the path?

- A 33.5m^2
 B 59.5m^2
 C 61.5m^2
 D 66m^2
- 2 The gardener decides to paint a white line around the perimeter of the path.
What is the perimeter of the path?
- A 33.5m
 B 58m
 C 61.5m
 D 66m

- 3 The diagram shows the dimensions of the front of a cold store building. The front of the cold store building is a rectangle and a triangle. This is all to be painted white.

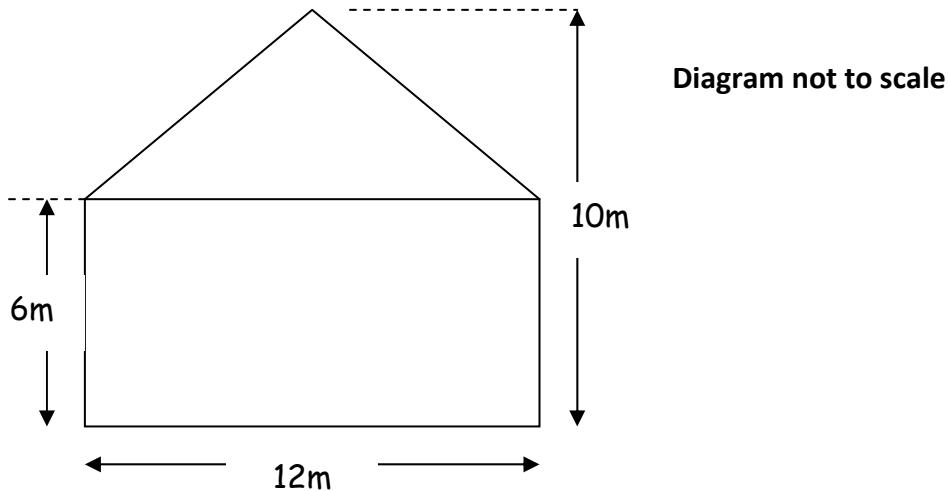

What is the area to be painted?

- A 24m^2
 - B 72m^2
 - C 96m^2
 - D 120m^2
- 4 The estates manager of a college decides to repaint one of the walls in the reception area. The diagram shows the dimensions of one of the walls that needs painting. The wall is 4m long and 2.5m high and has a large fixed bookcase in one corner. What is the area of the section of the wall that needs painting?

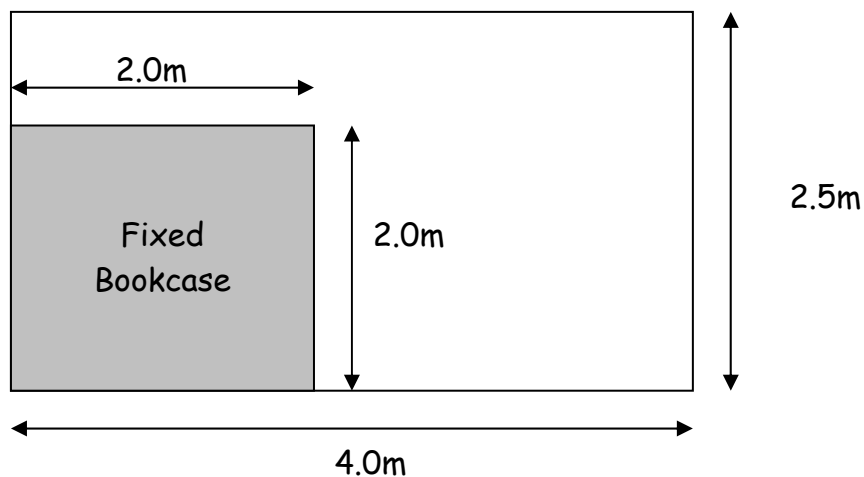

- A 4.0m^2
- B 5.0m^2
- C 6.0m^2
- D 10.5m^2

- 5 The diagram shows the floor plan of the paint quality assurance department.

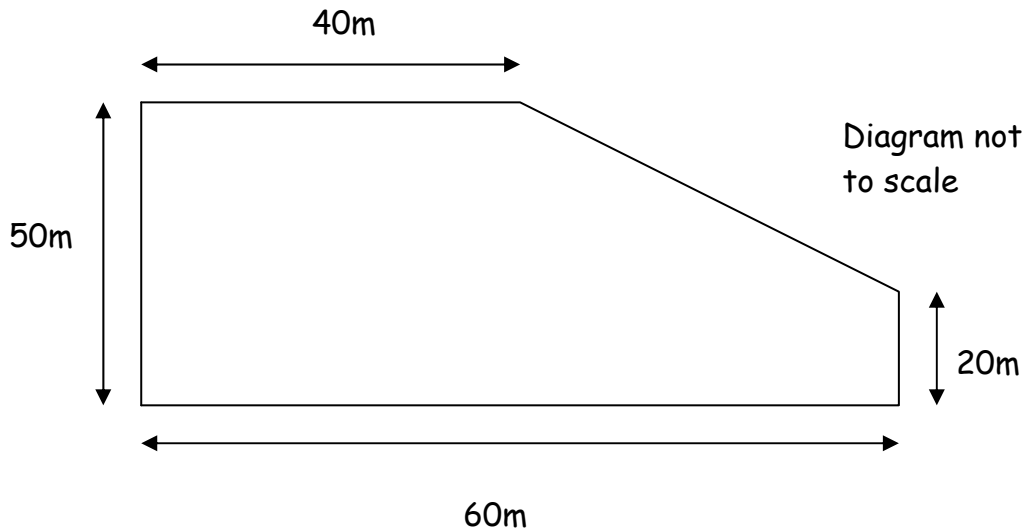

What is the area of the floor?

- A 170m^2
 - B 270m^2
 - C $2\,700\text{m}^2$
 - D $3\,300\text{m}^2$
- 6 At the end of the season the owner replaces the carpet in one of the rooms with carpet tiles. Each tile is a square with sides of 0.5 metres. The sketch shows the dimensions of the room.

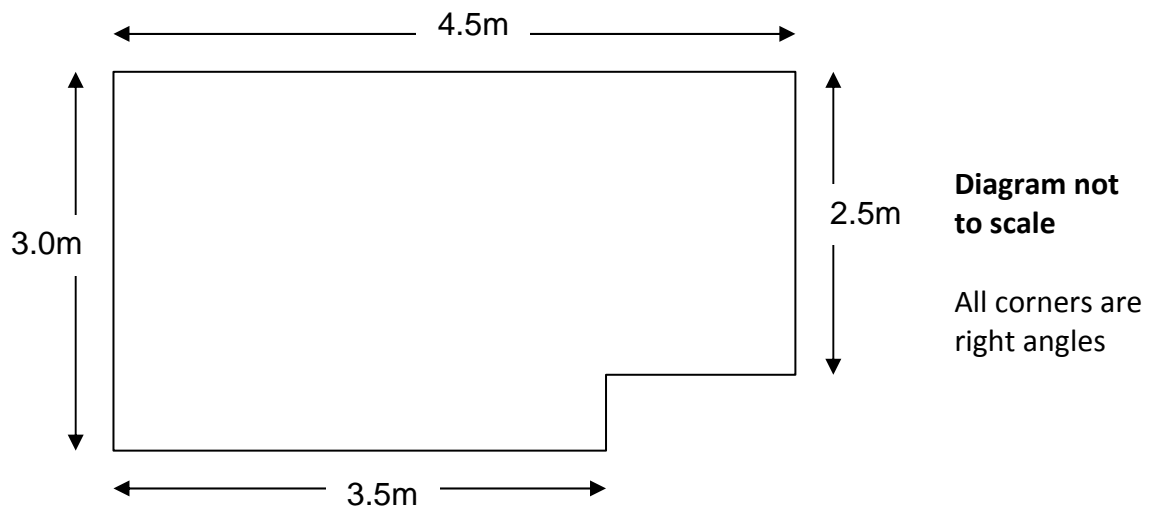

How many carpet tiles does she use?

- A 27
- B 30
- C 52
- D 87

- 7 A charity holds a fund-raising fete. A woman designs a game that is played by rolling pennies on the table in the diagram. She works out the areas marked **WIN** and the shaded area to decide how much prize money to offer. What area of the table is **shaded**?

Diagram of top of table

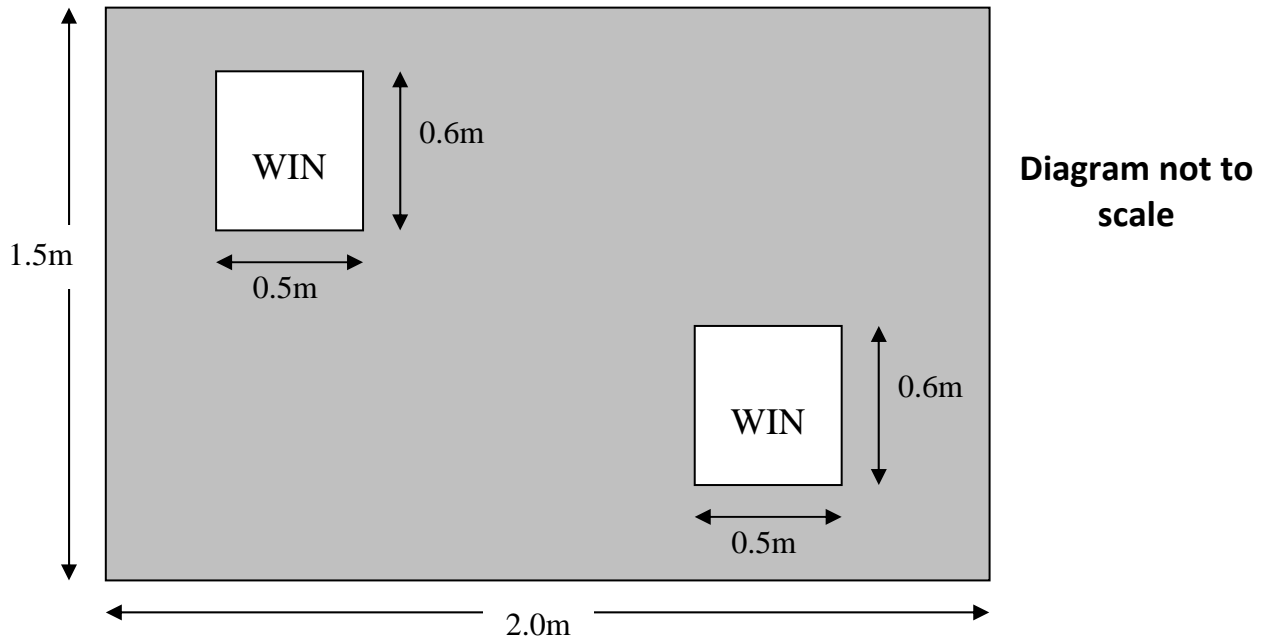

- | | | | |
|----------|-----------------|----------|-----------------|
| A | 1.3m^2 | C | 2.6m^2 |
| B | 2.4m^2 | D | 3.6m^2 |

- 8 The designer plans a new wall. The sketch plan below shows the trench for the concrete foundations. The concrete foundations need to be 0.4 metres deep.

Plan of trench for concrete foundations

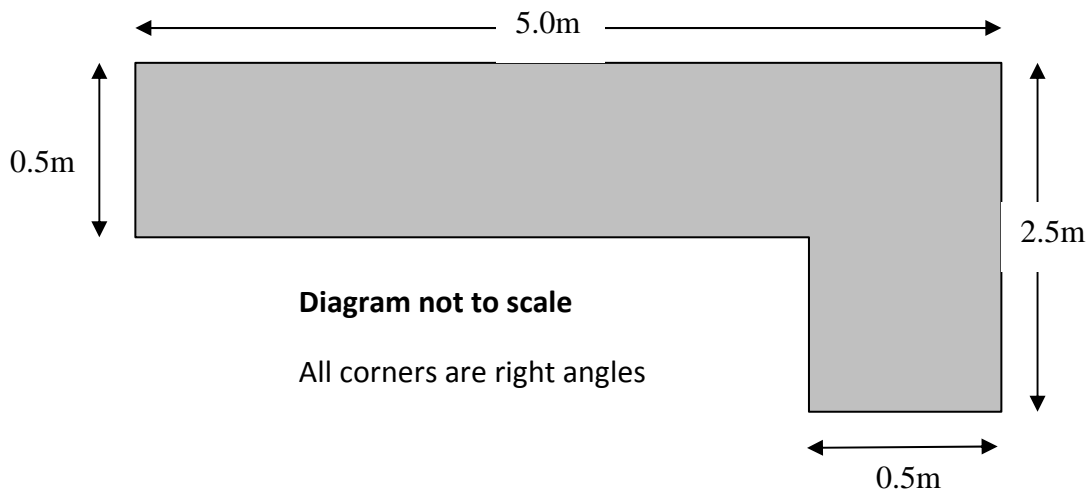

What volume of concrete will fill the trench to 0.4 metres deep?

- | | | | |
|----------|-----------------|----------|-----------------|
| A | 1.4m^3 | C | 3.4m^3 |
| B | 1.5m^3 | D | 3.5m^3 |

9 A tourist information centre has a new extension.

Tourist information centre extension

What is the area of the extension?

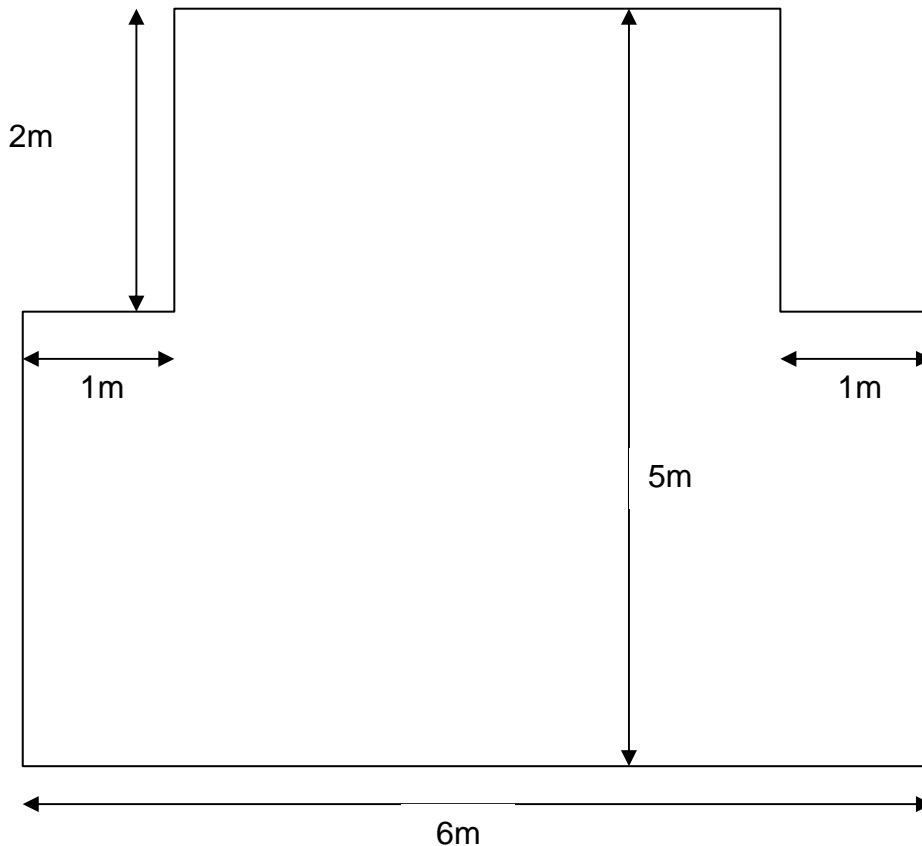

**Diagram not
to scale**

All corners
are right
angles

- A 15m^2
- B 22m^2
- C 24m^2
- D 26m^2

10 The tourist board want to attach a gold strip all around the border of the floor of the building.

What is the perimeter of the new extension?

- A 15m
- B 22m
- C 24m
- D 26m